

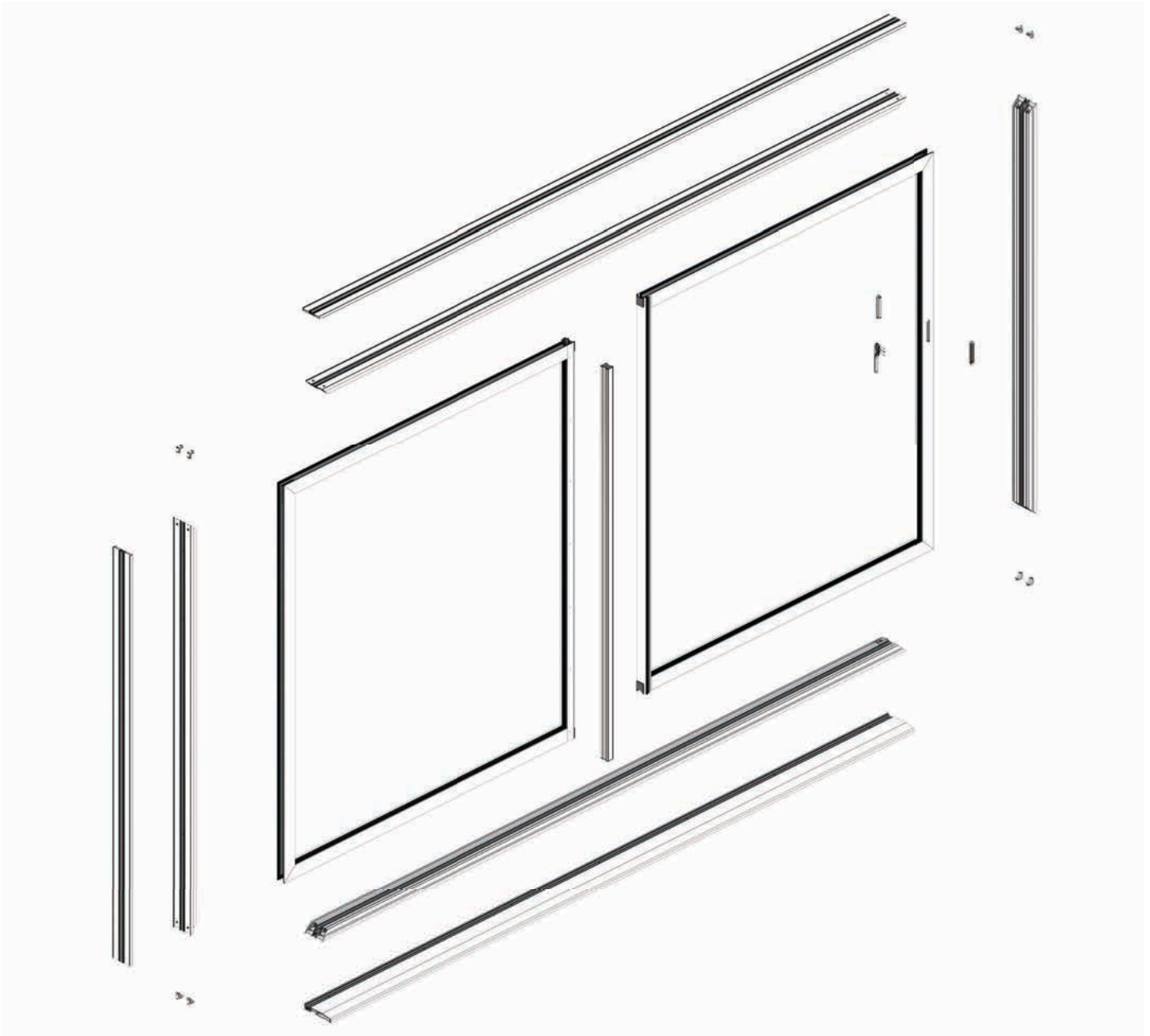

# Cortizo 4700 Slider

## Installation Guide



## TOOLS / PARTS REQUIRED



Tape measure



Soft mallet

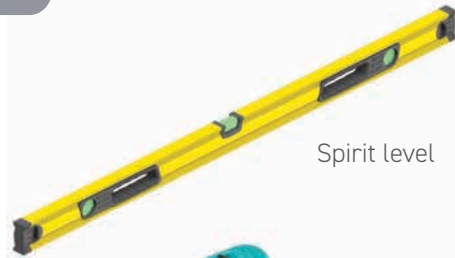

Spirit level



4mm hex key



Glazing paddle



Glazing suction lifters



Cordless  
drill / driver



Pozi Bit



6 & 10mm  
Drill Bits

# PACKAGING CONTENTS

Not to Scale



Anti-lift Block  
A-07080



Door Stop  
A-07147



Frame Cleat (Kit Form)  
TRIPLE TRK A07417 / DOUBLE TRK A07153



External Trickle Vent  
A-05774



Internal Trickle Vent  
A-05774

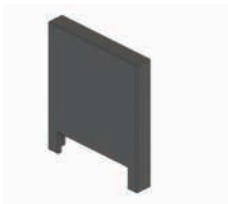

Interlock Cap  
A-07150

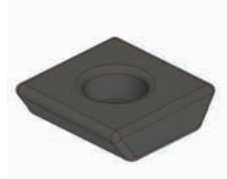

Sash Fixing Spacer  
A-07102



Shoot-Bolt Key  
A-03106



16mm Extender Screw  
A-07437



38mm Extender Screw  
A-07436



Anti-lift Block Screw  
A-07401



Head Drip Screw  
A-07400



Reinforcement  
Fixing Screw  
A-07402



Sash-Fixing Block-Sash  
Fixing Screw  
A-07105



Door Stop Screw  
A-07435

# CONSUMABLES NOT SUPPLIED



Low modulus  
silicone sealant



Structural sealant



Outer frame  
U packers



G Packers

# KB - ASSEMBLE FRAME

# 1

4mm hex key

Low modulus silicone sealant

Frame cleat

Assemble frame ensuring profile edges are sealed. Tighten cleats with 4mm Allen key

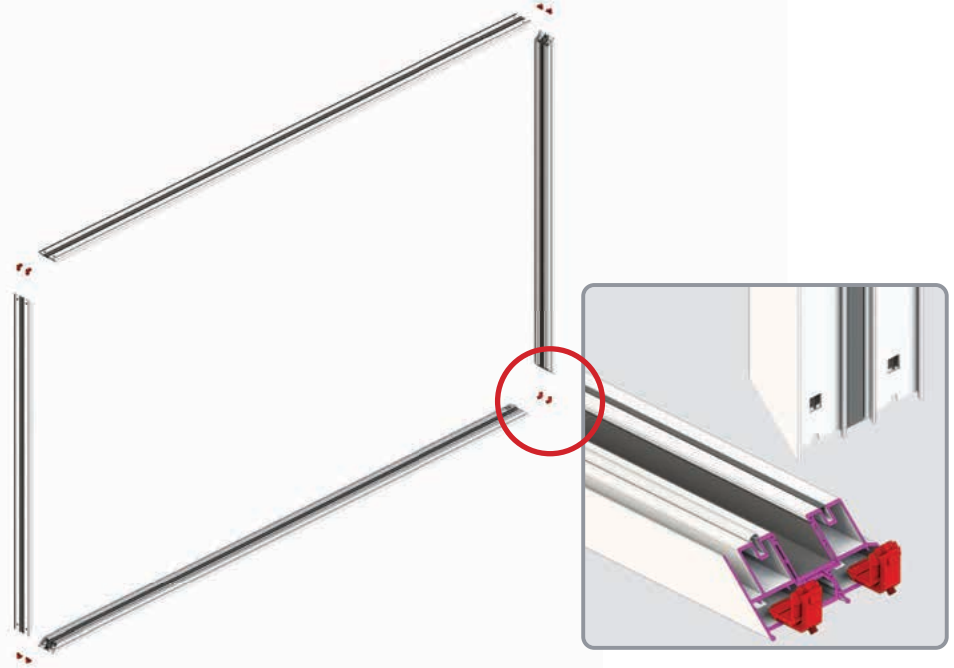
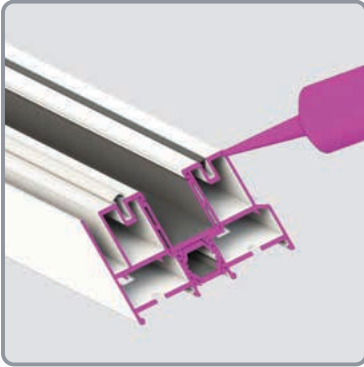

Ensure mitres are correctly aligned



Seal cleats



# KB - FITTING FRAME EXTENDER

2



Low modulus silicone sealant



16mm extender Screw



38mm extender screw

Apply silicone to sides where extenders are located only

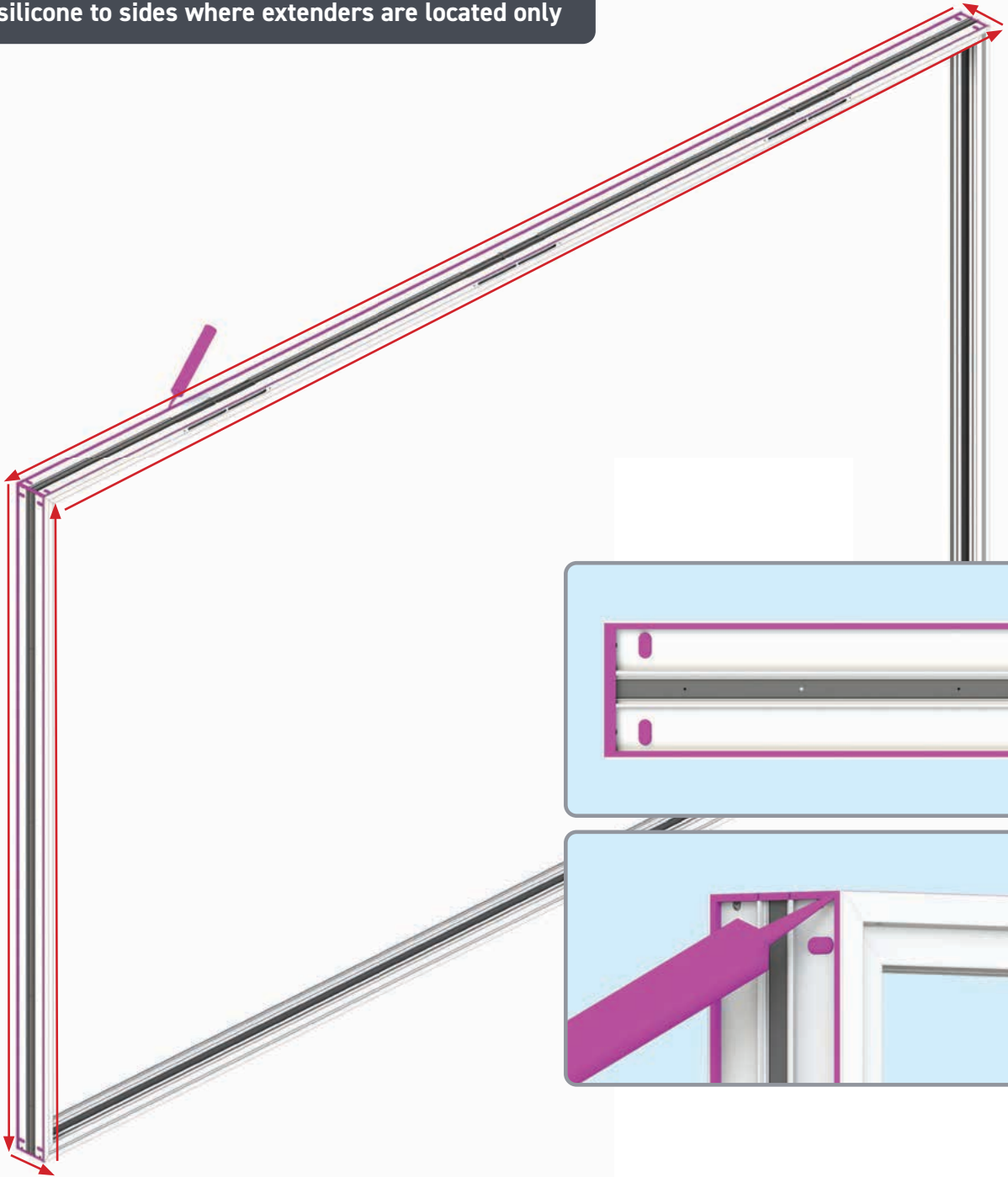

Shown on all sides for illustration purpose only

Place extender to top of frame

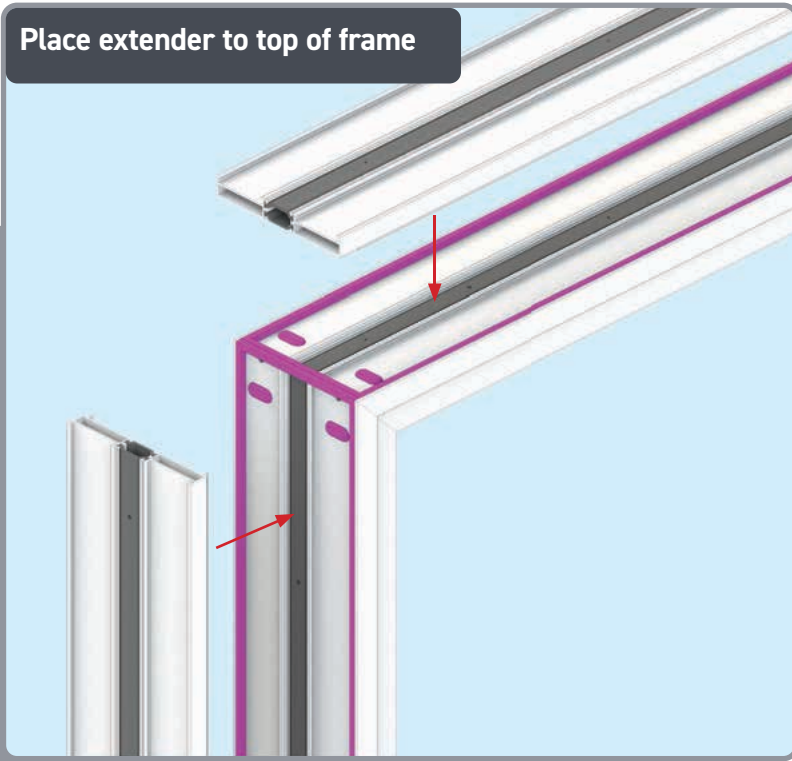

Ensure profile sits flush to frame profile



Fix extender to frame using screws provided. A-07437 screw for 16mm extender and A-07436 screw for 38mm extender. 1. screw 50mm from end, 2. screw 50mm either side of any trickle vent. 3. max 300mm spacing between remaining screws

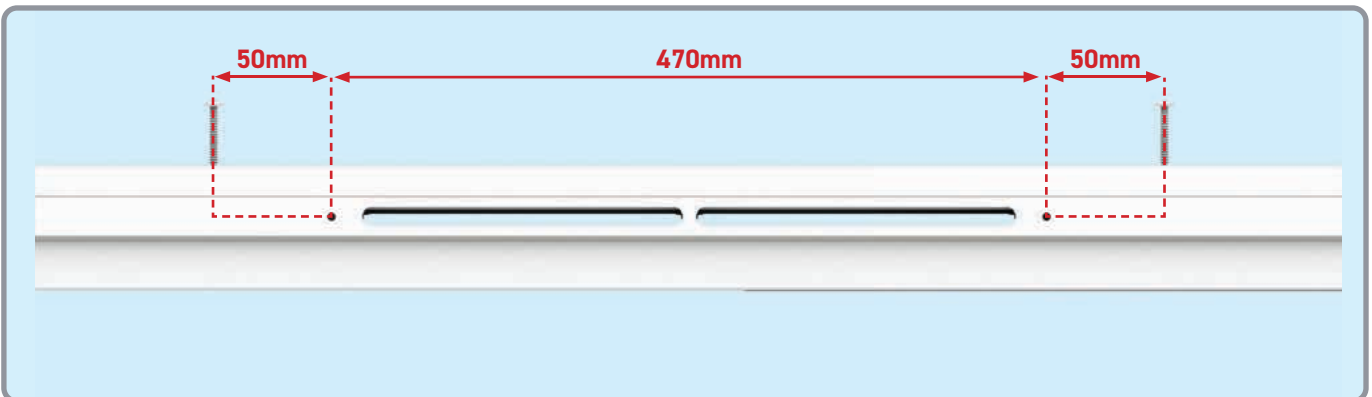
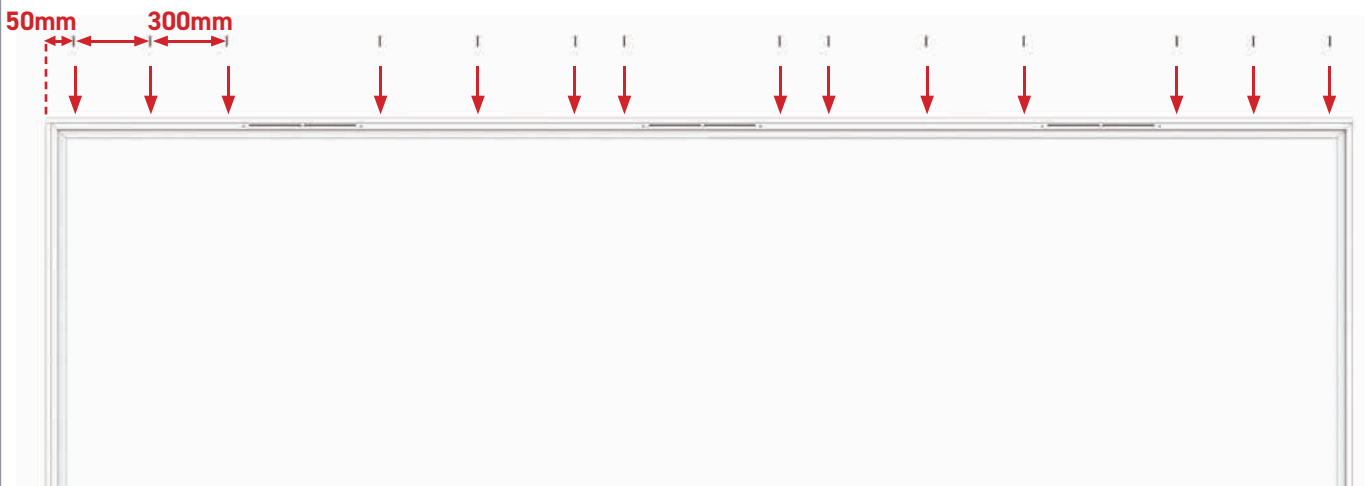

Fix extender to frame using screws provided. A-07437 screw for 16mm extender and A-07436 screw for 38mm extender. 1. screw 50mm from end, 2. max 300mm spacing between remaining screws



Fix extender down into frame thermal break

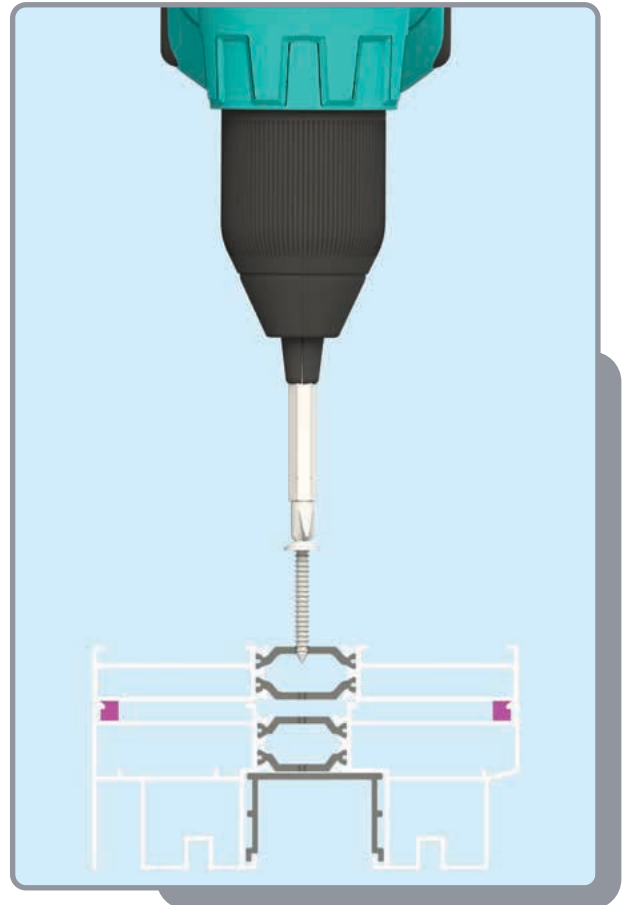

# PB - REMOVE SASHES FOR FRAME INSTALL

## 3



Shoot-Bolt Key

Open shoot bolt handle and remove sashes to ready frame for install

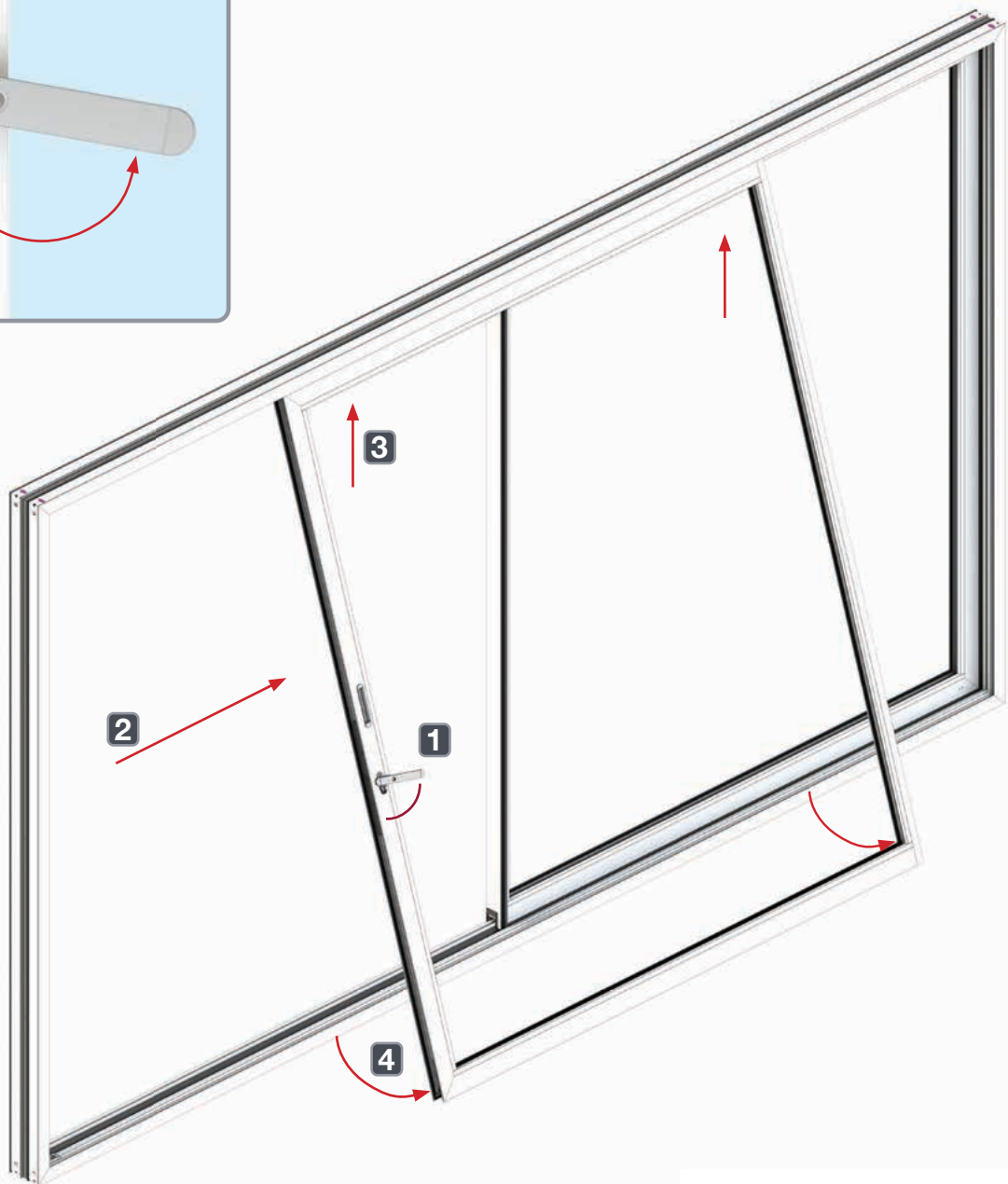



# KB AND PB CILL INSTALL

4



Low modulus silicone sealant



Outer frame U packers



6 & 10mm Drill Bits

Pack and level cill before fixing. Place packers 150mm in from the brickwork and no more than 600mm

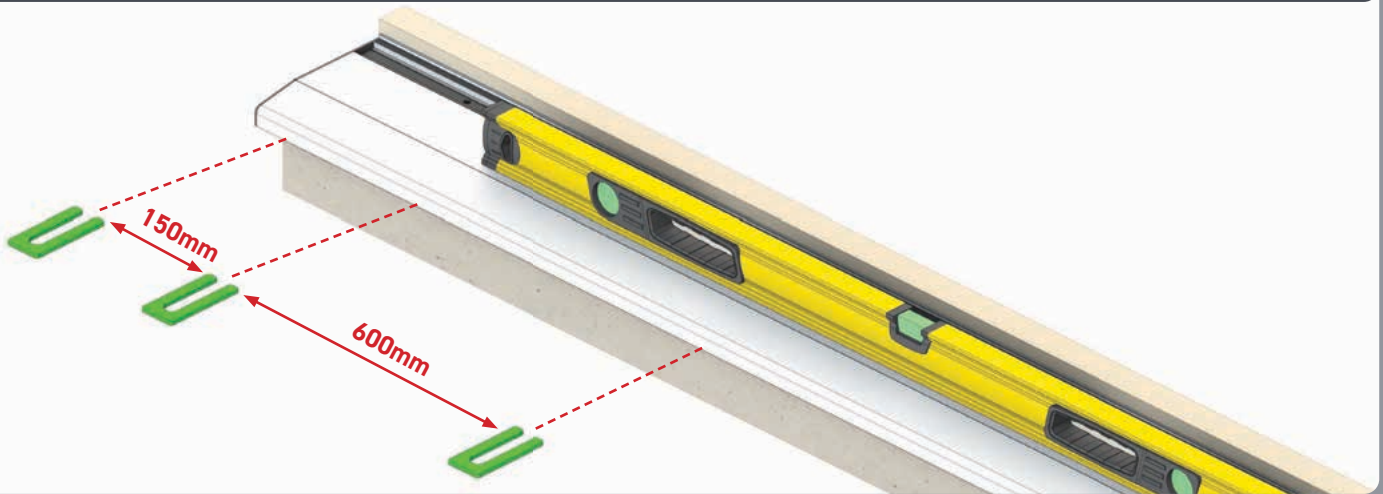

Drill pilot holes spaced 150mm from the brickwork and no-more than 600mm apart

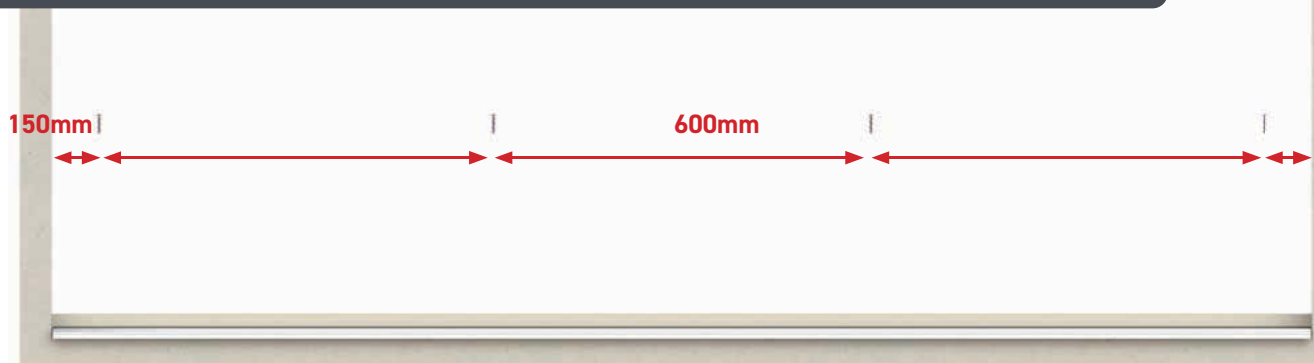

Pilot thermal break and concrete using 6mm drill bit ready for a 7.5mm masonry screw

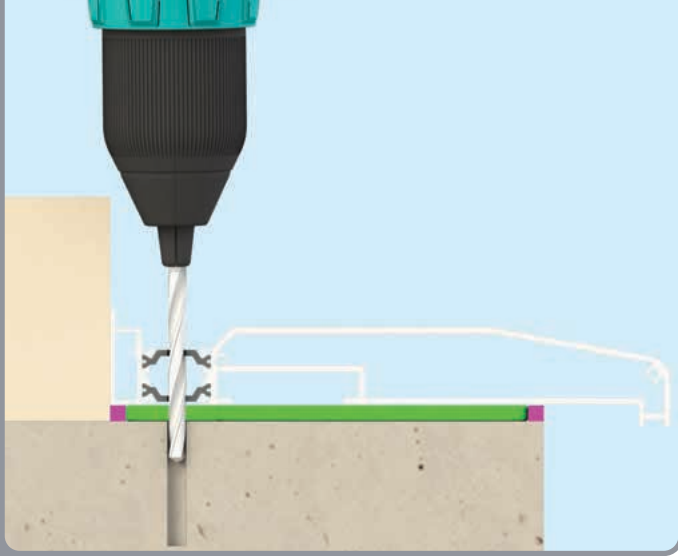

Followed by a 10mm pilot through the upper thermal break only

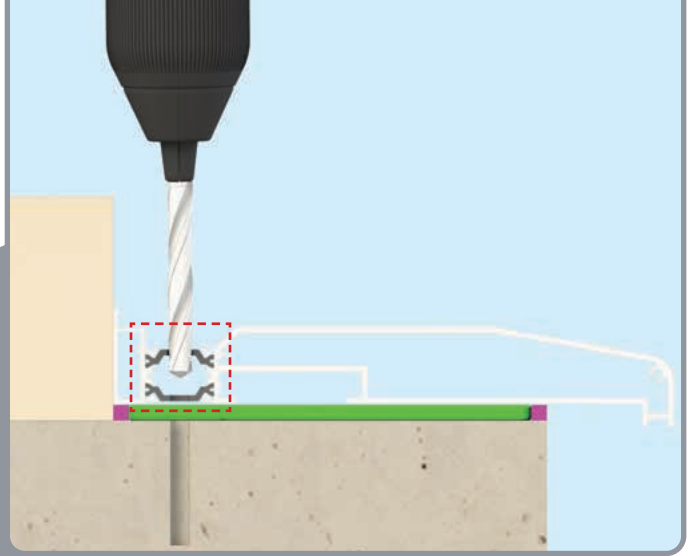

Fix cill to brickwork using masonry screws

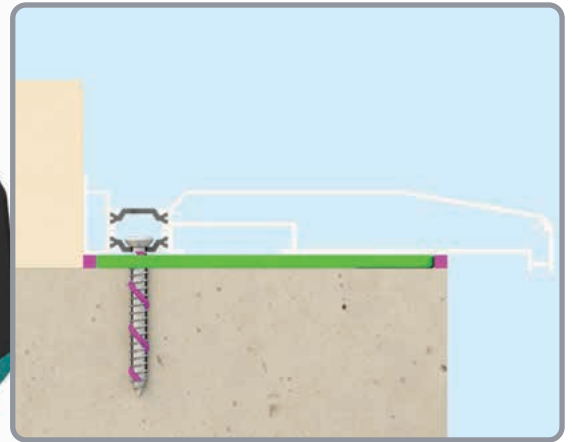
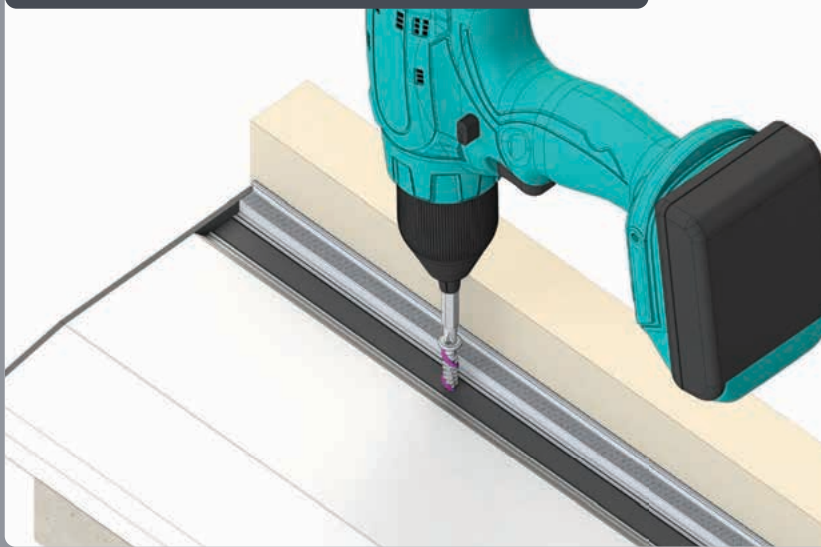

Seal frame to cill where shown

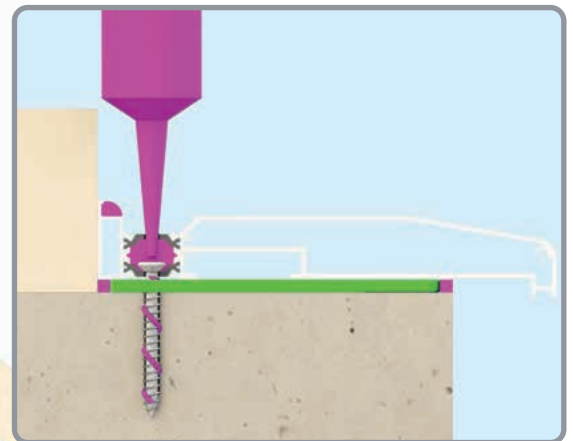
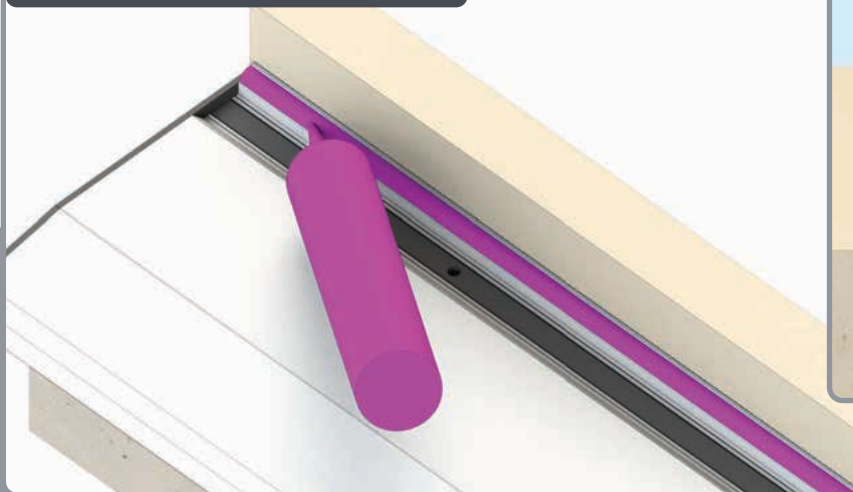

# INSTALL FRAME

## 5



Low modulus silicone sealant



Outer frame U packers



6 & 10mm Drill Bits

Before installing frame run a bead of silicone across the back of the threshold

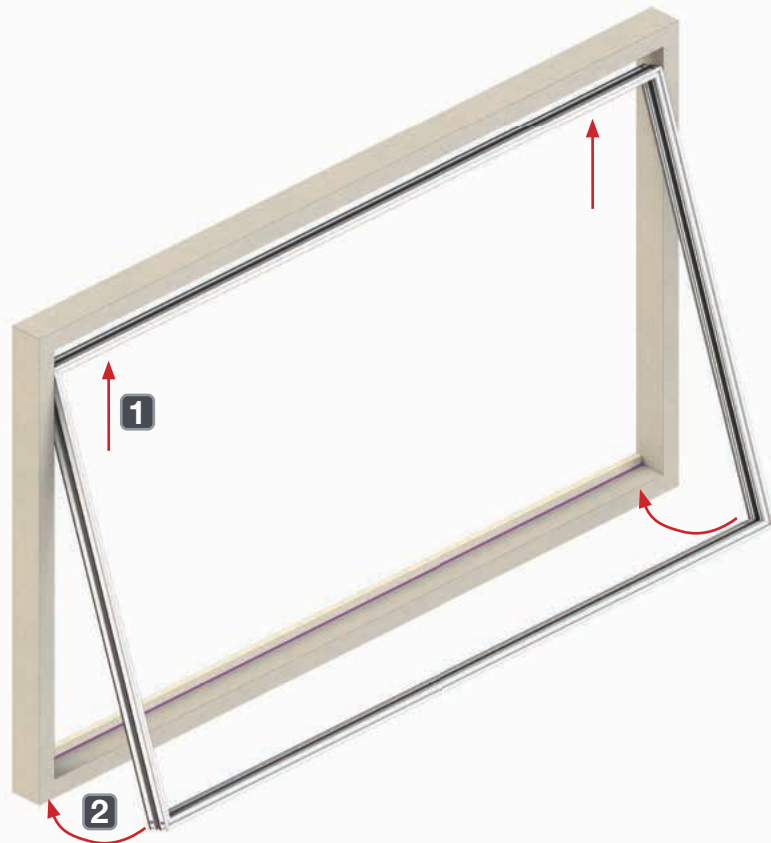
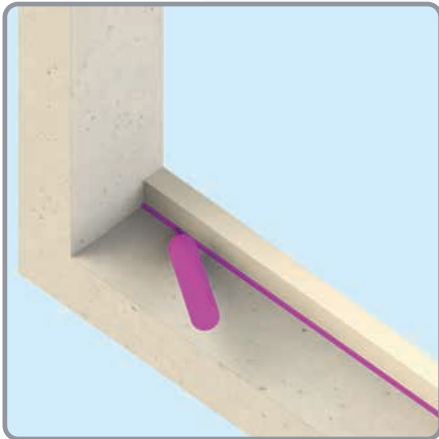

Pack and level frame before fixing

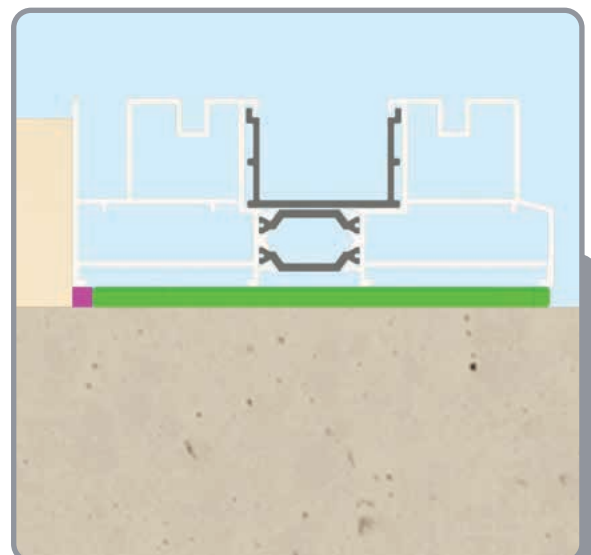
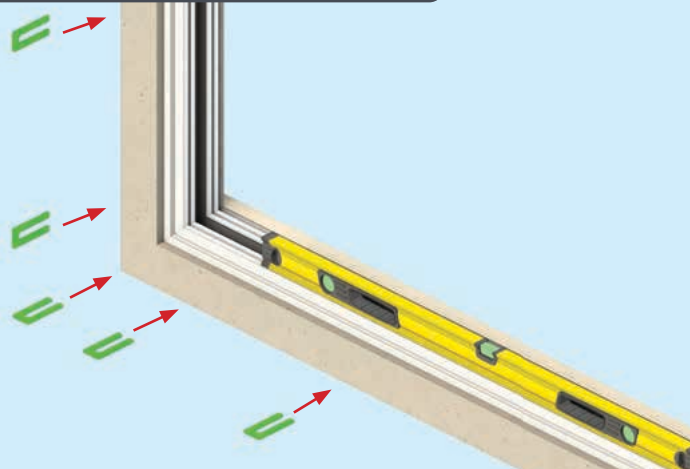



**Pilot hole to track isolator - ensure hole is measured as below (not central)**

**Do not pilot holes central to track isolator**

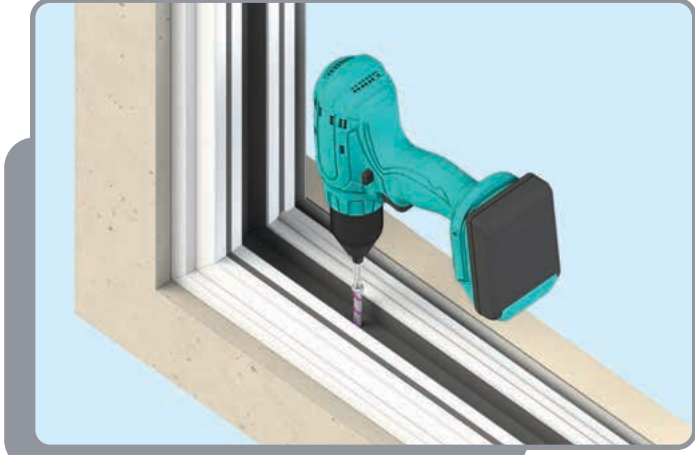
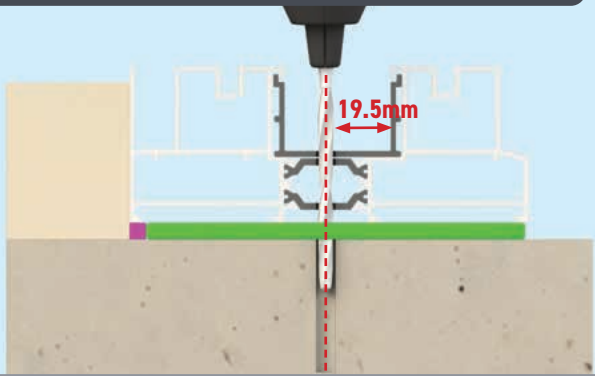

**Pilot thermal break and concrete using 6mm drill bit ready for a 7.5mm masonry screw**

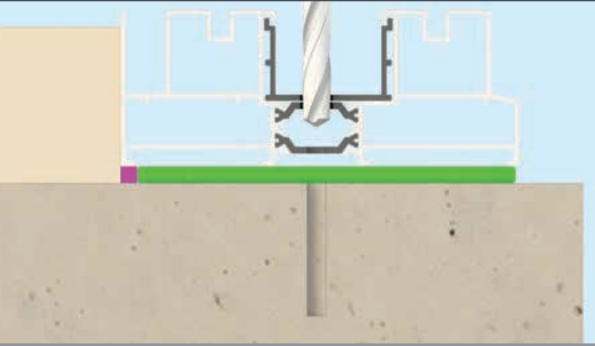

**Followed by a 10mm pilot through the upper thermal break only**

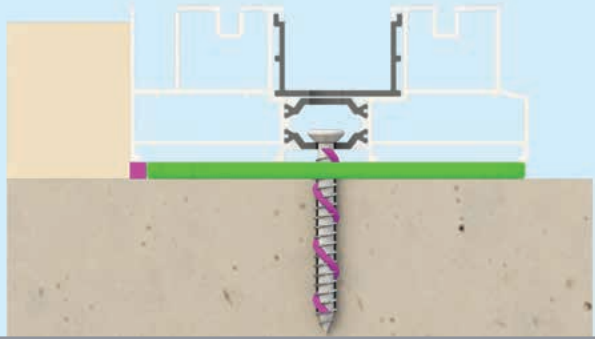

**Fix frame into brickwork using 7.5mm masonry screws. Recommended to plug screw holes**



# SASH INSTALL ORDER

## EXTERNAL VIEW

 Top anti-lift block location  
(bottom block fitted in factory)

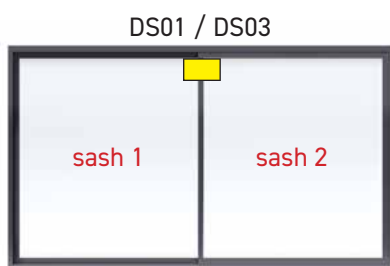

INSTALL SEQUENCE: 2,1

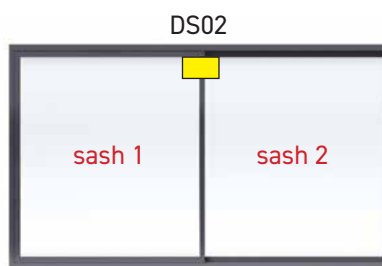

INSTALL SEQUENCE: 1,2



INSTALL SEQUENCE: 3,1,2



INSTALL SEQUENCE: 1,3,2



INSTALL SEQUENCE: 1,2,3

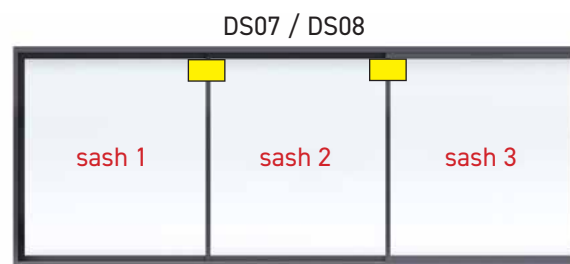

INSTALL SEQUENCE: 3,2,1



INSTALL SEQUENCE: 1,4,2,3

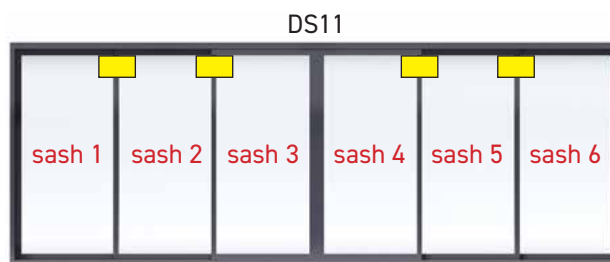

INSTALL SEQUENCE: 1,6,2,5,3,4

# INSTALL OUTER SASH

# 6

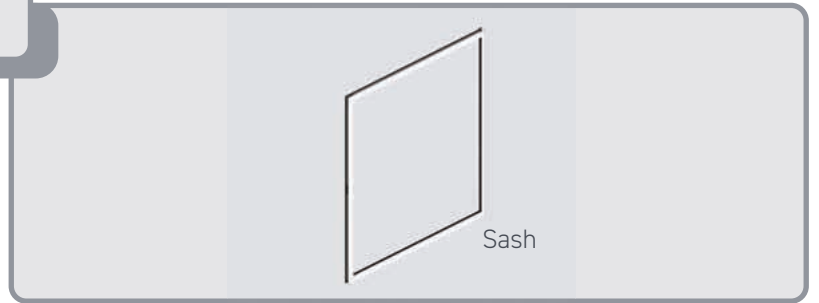

Lift top of sash into frame before swing and then lower into place. Move sash into place over fixing blocks

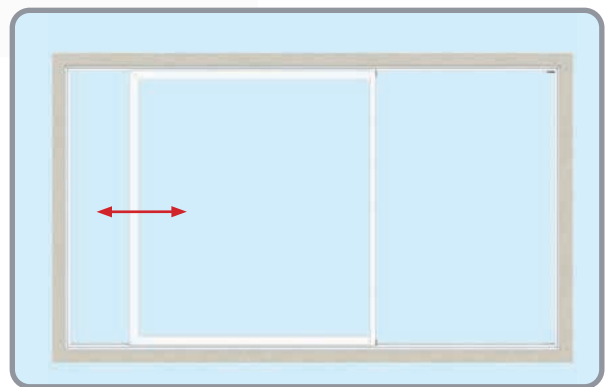
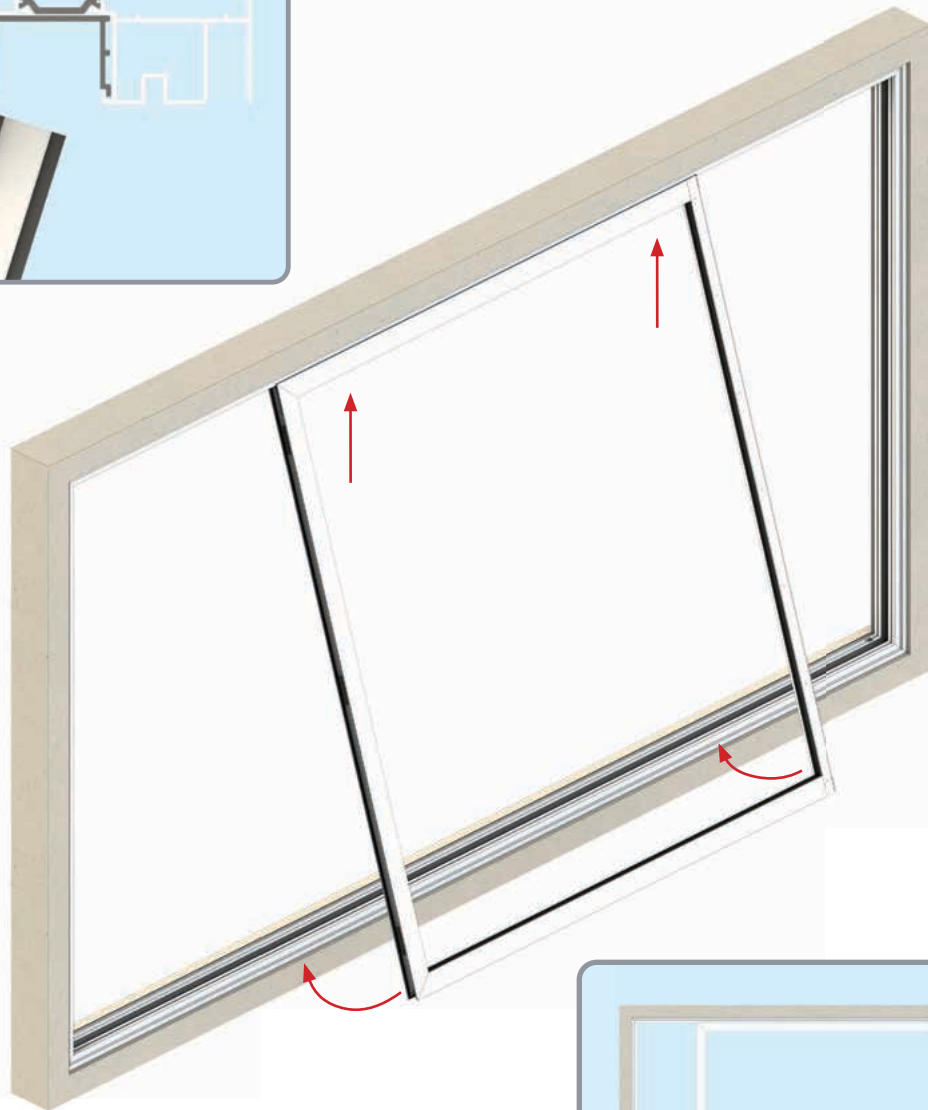
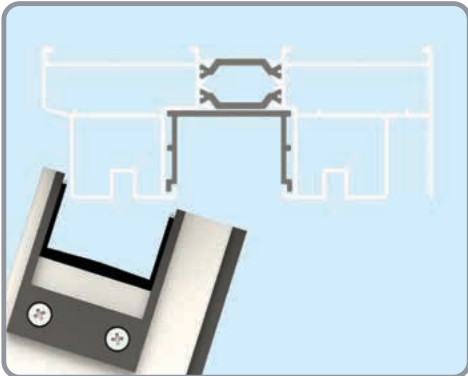

# SECURING FIXED DOOR TO FRAME

7

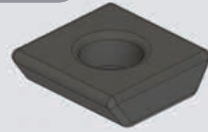

Sash Fixing Spacer



Sash-Fixing Block-Sash Fixing Screw

Fix door into position using screws provided through shown machining's. Fix vertical screws first to help align door with horizontal fixing points

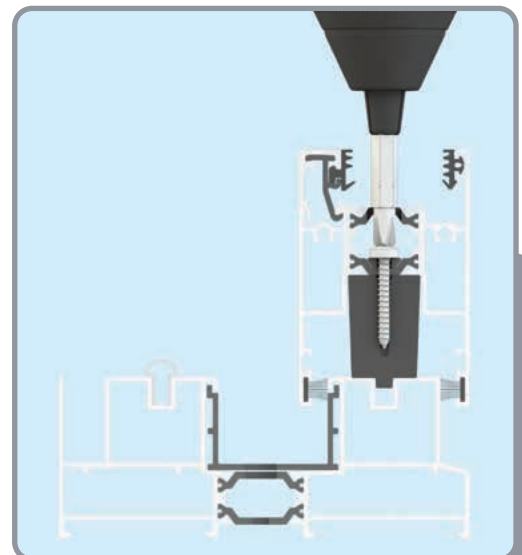
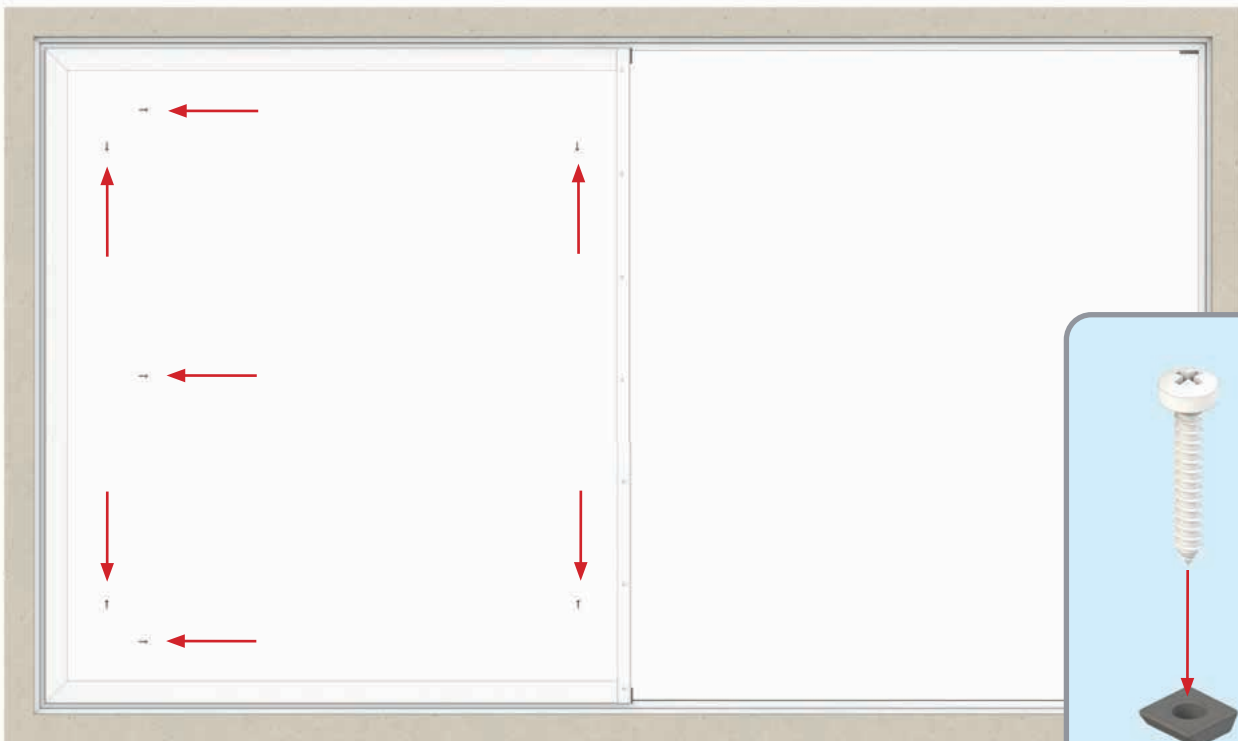

# KB - ANTI LIFT BLOCK

8



Anti-lift Block

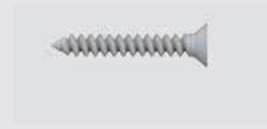

Anti-lift Block Screw

Slide anti-lift block up and over the top sash, aligning with screw holes



Fix block into place. Note that access will be needed on either side of door

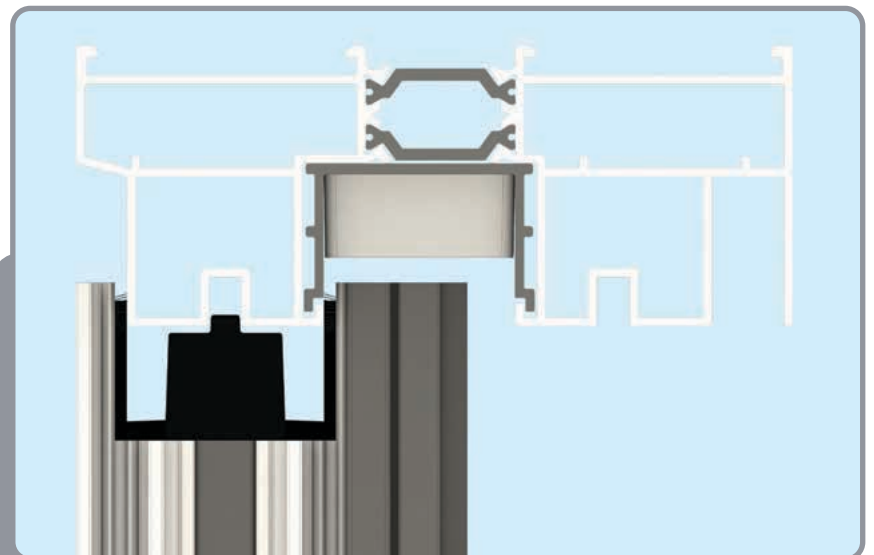
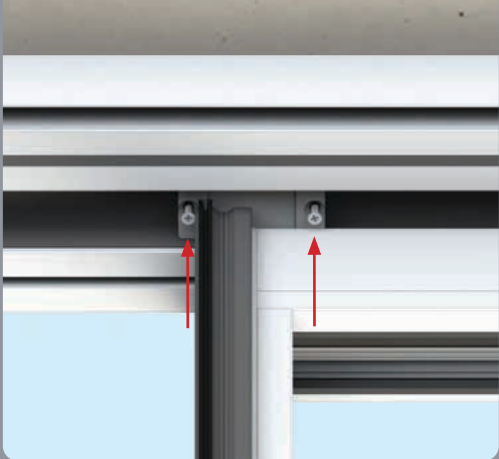



# GLAZING

## 9



Low modulus silicone sealant



Glass



Beads



G Packers

Remove vertical beads followed by the horizontal

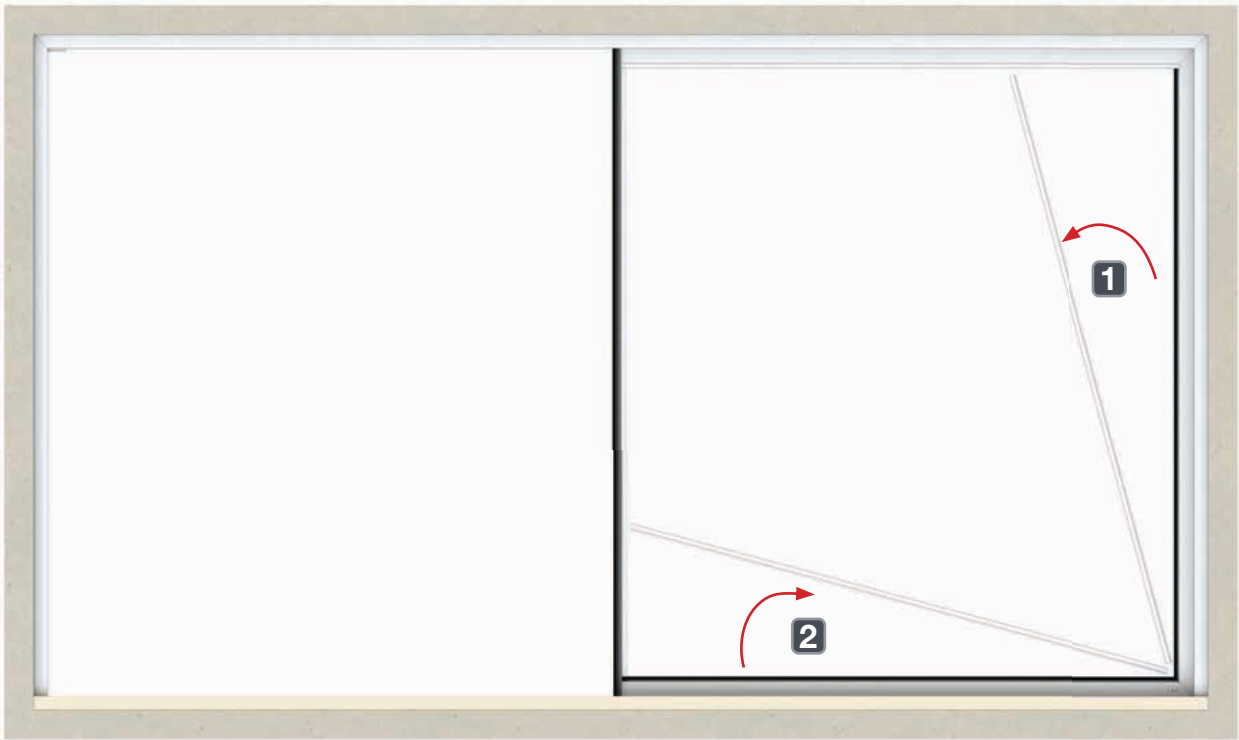

Remove bead by pinching sides, be sure to remove all polystyrene block spacers

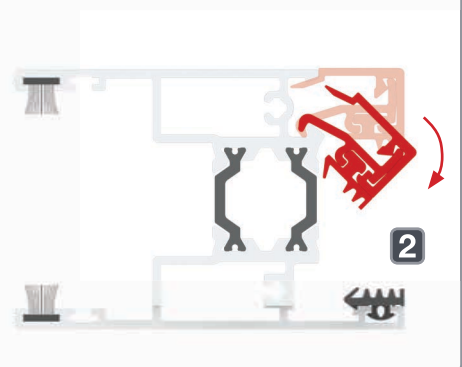
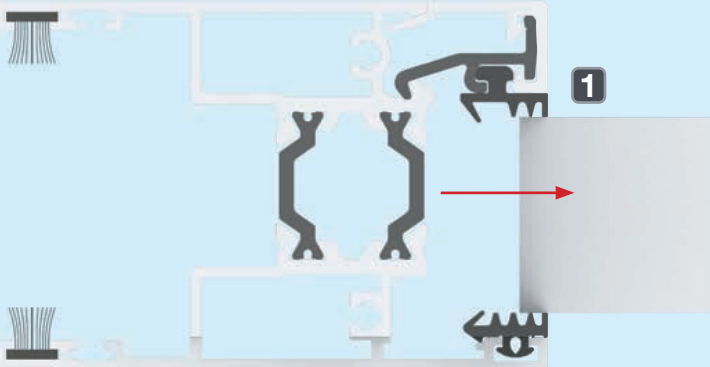

Fit lower glazing packers before placing the glazing panel into sash

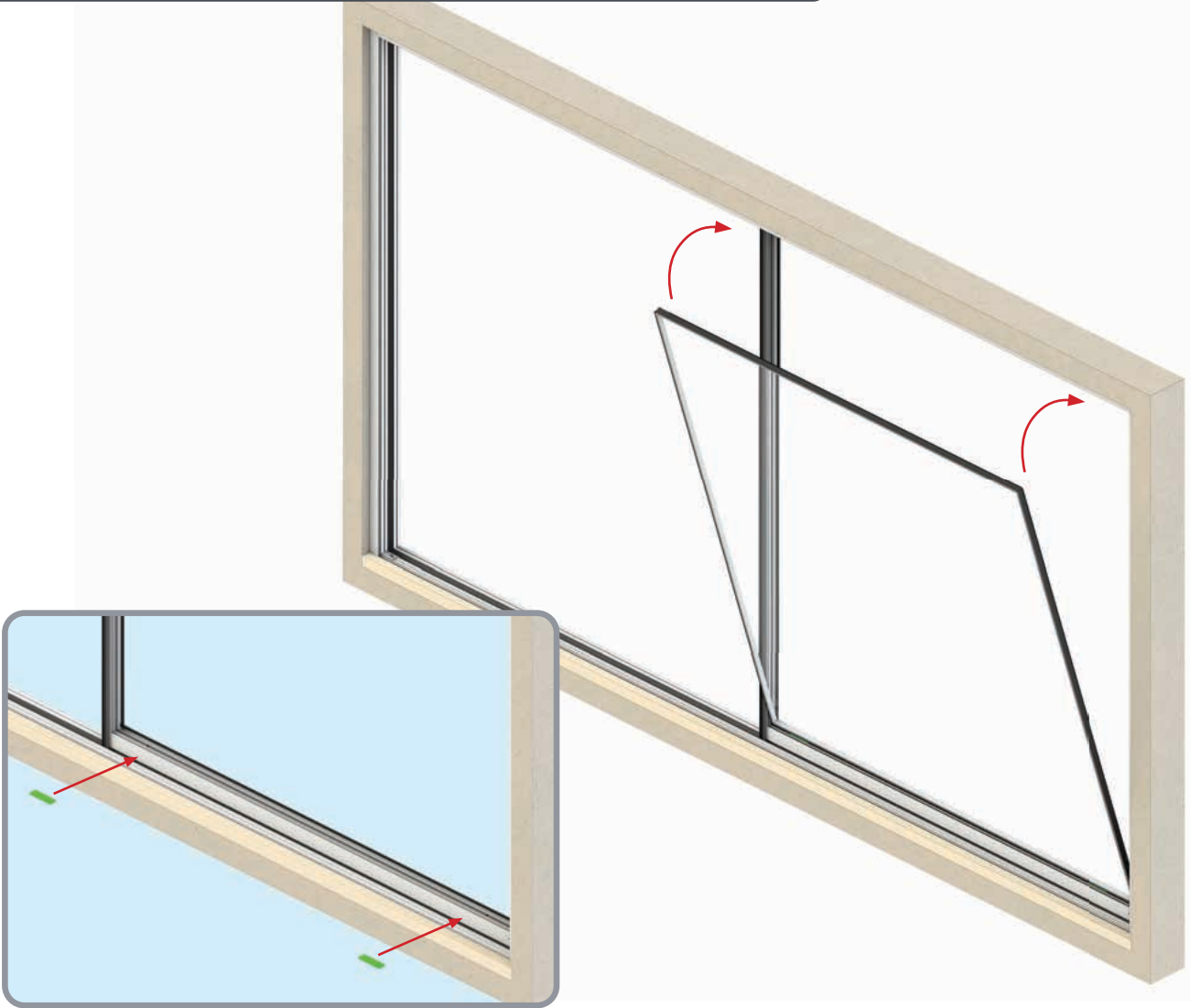

Fully pack glass before refitting clip beads

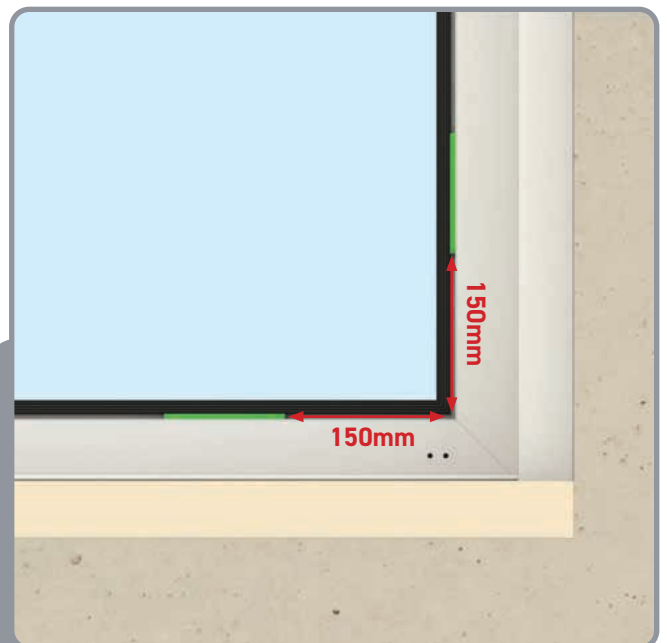
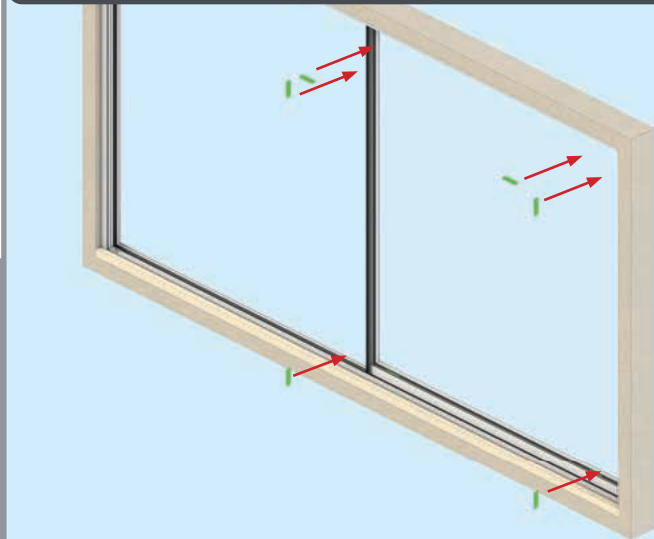

Fit horizontal beads before applying structural sealing

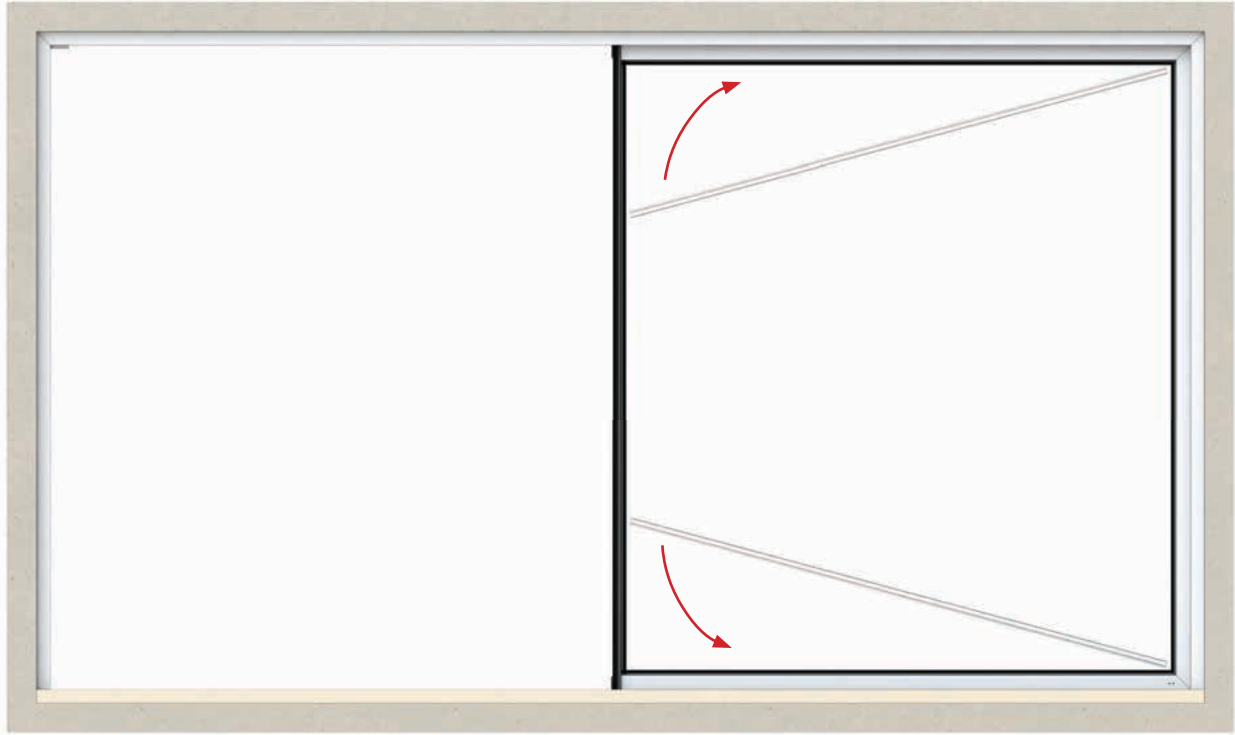

Run a bead of sealant 200mm long every 200mm (only on door greater than 1800mm vertical)

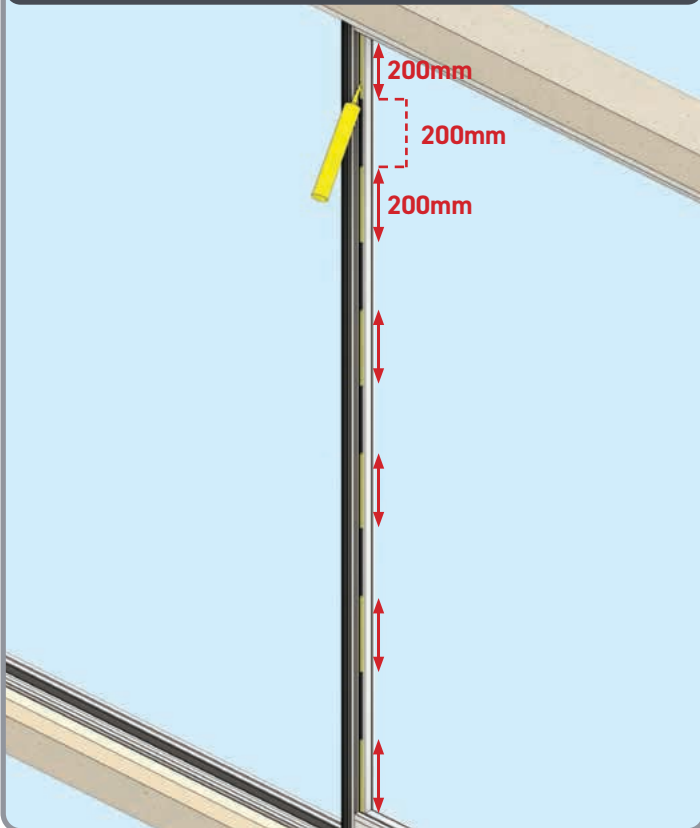

Allow to dry/set for 48 hours

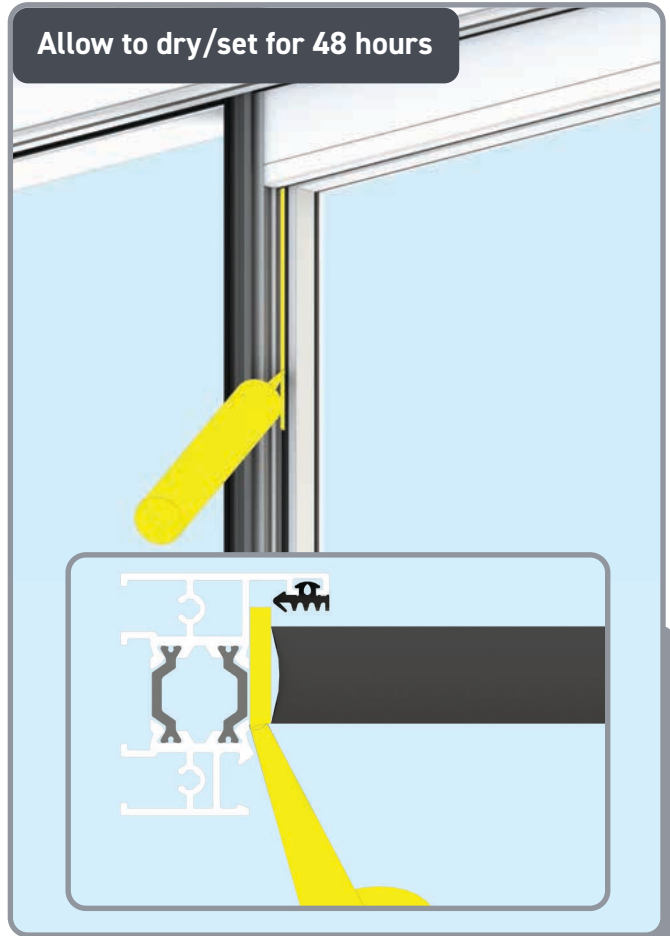

Must use recommended 'Dowsil 895' sealant - (not provided)

Fit the vertical beads

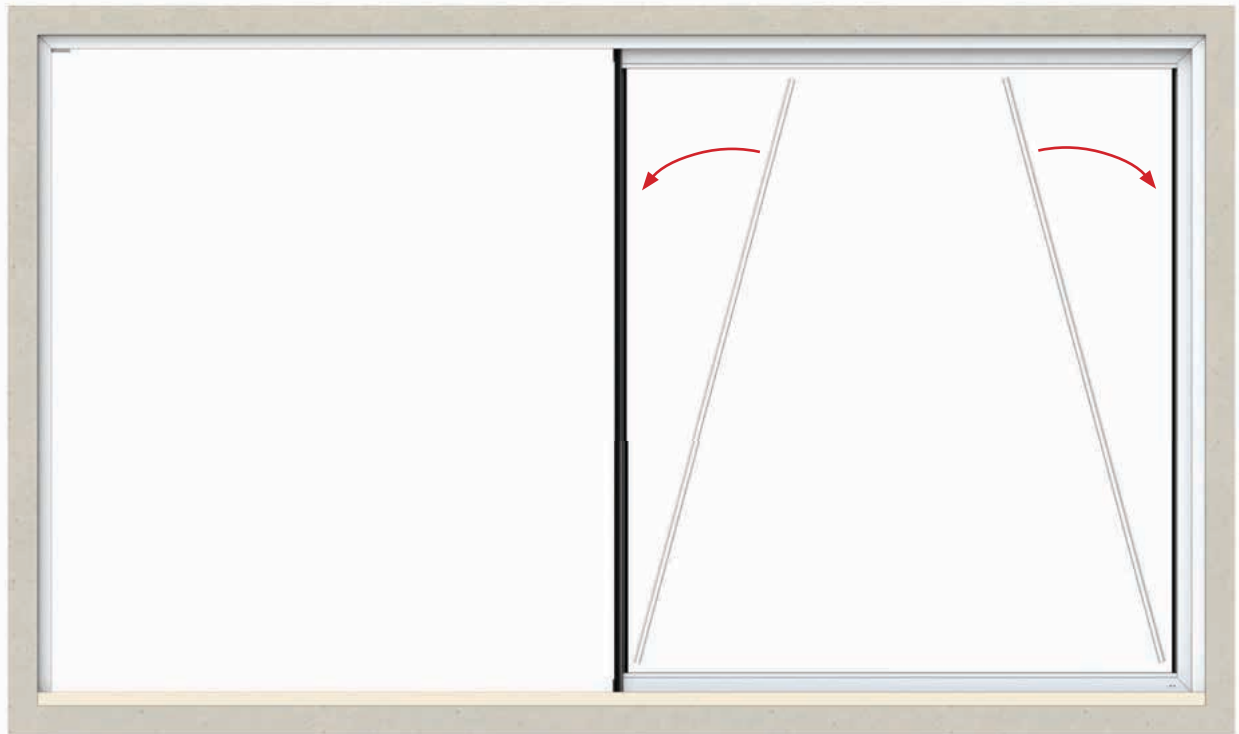

Double Glazing - Clip bead in as shown

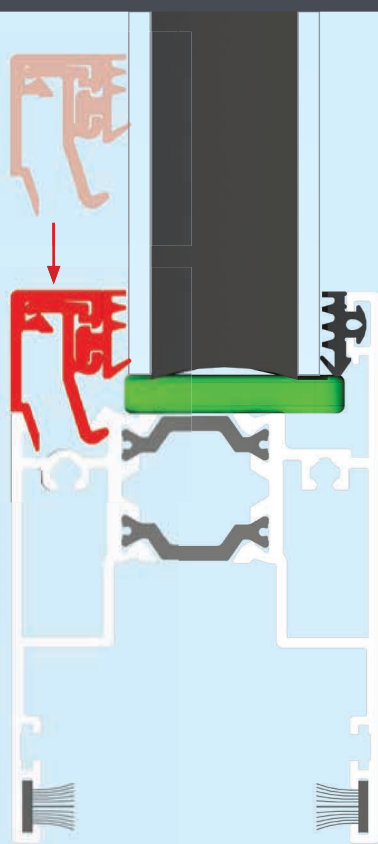

Triple Glazing - Clip bead in as shown

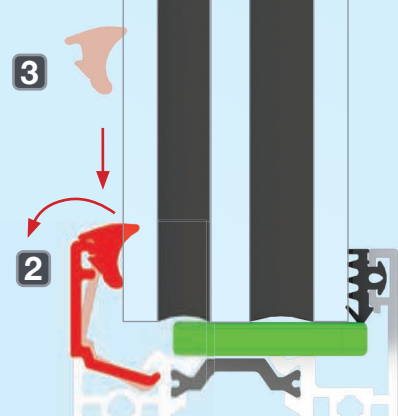
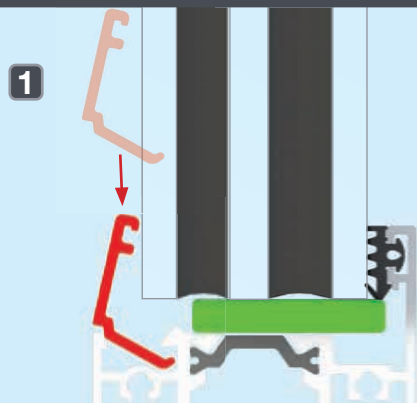

## INSTALL INNER SASH

10

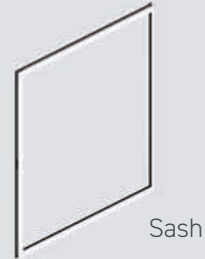

Lift top sash into frame before swing and then lowering into place. And move into final position

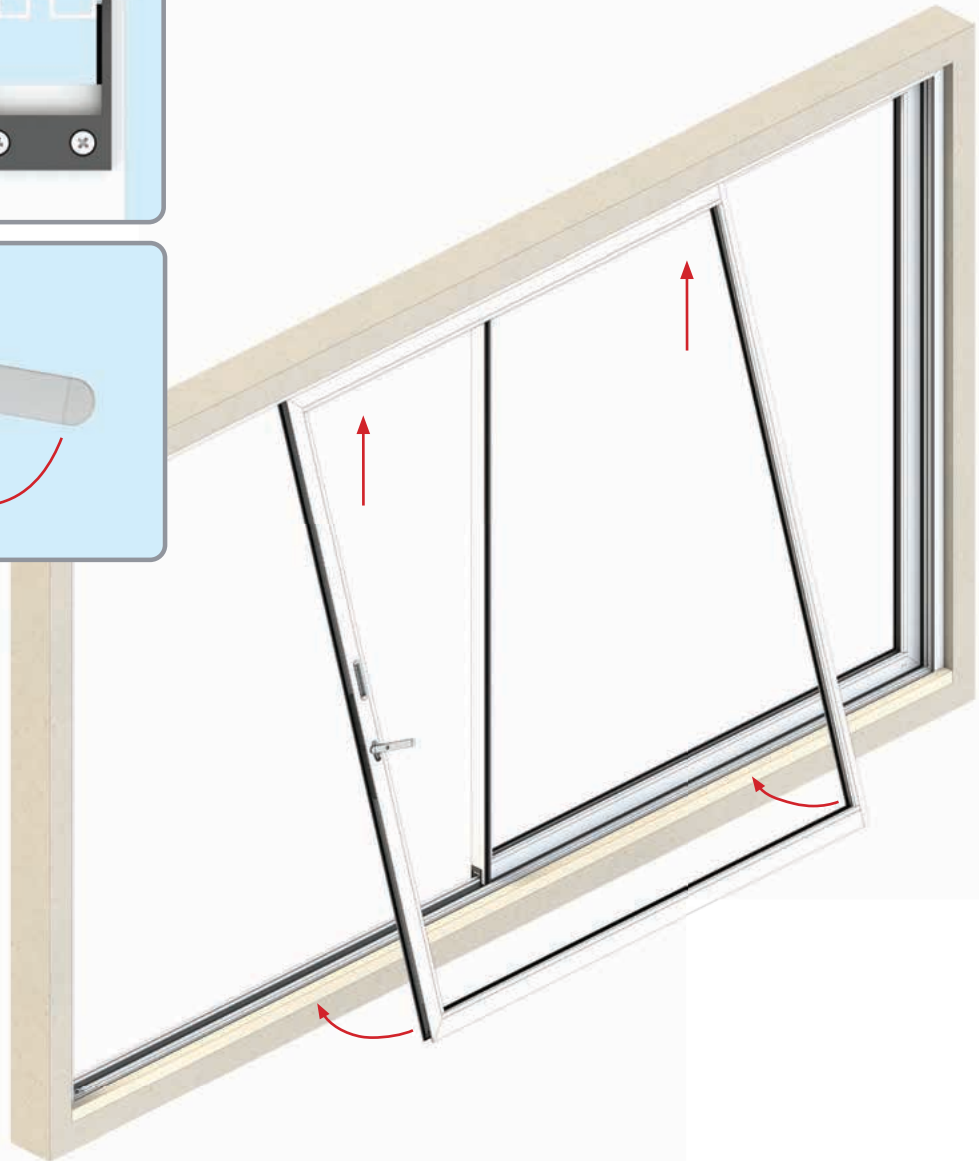
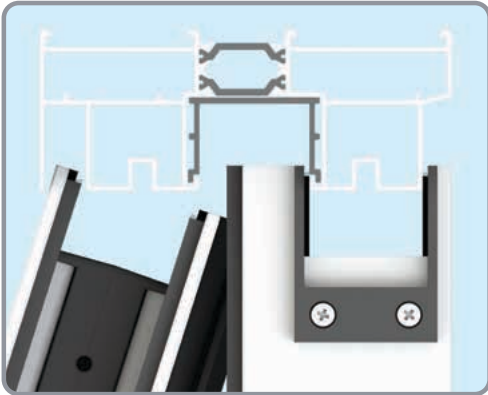

Refer back to Step 9 for glazing instructions

# FIXED SASH INTERLOCK TRIM COVER INSTALL

11



Soft mallet

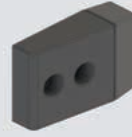

Door Stop



Door Stop Screw



Interlock Cap

Clip interlock cover into place. Ensure door functionality before moving on

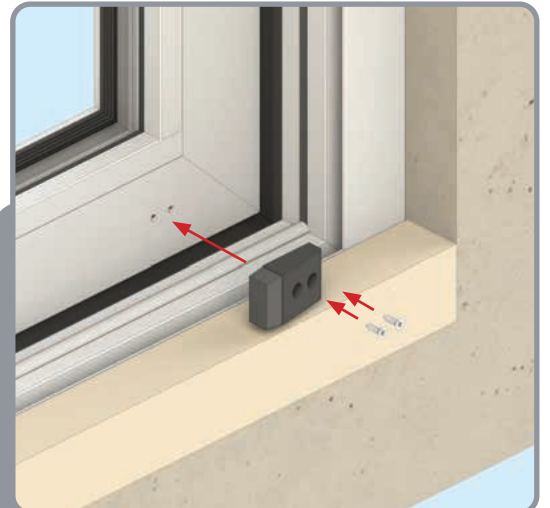
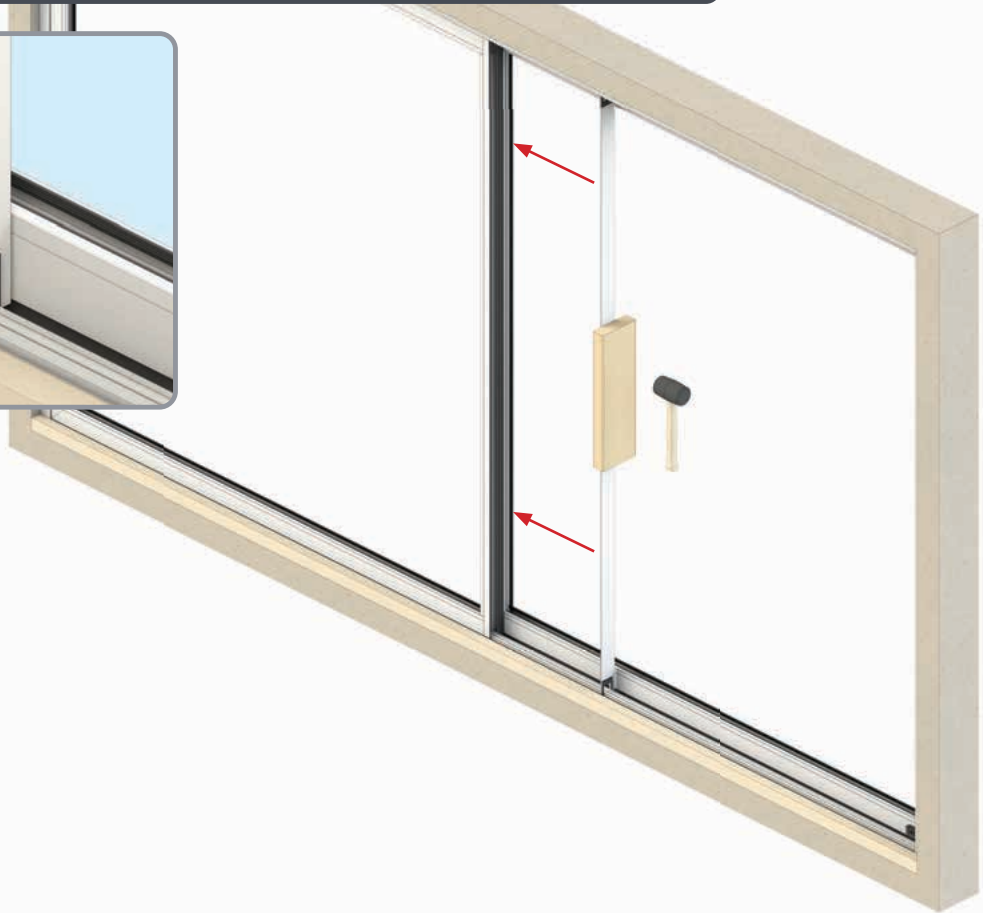
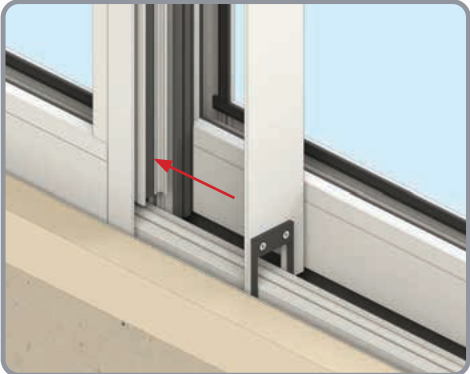

# HEAD DRIP COVER

# 12



Low modulus silicone sealant



Head Drip Screw

Run a bead of silicone before offering drip cover into place, fixing using screws provided

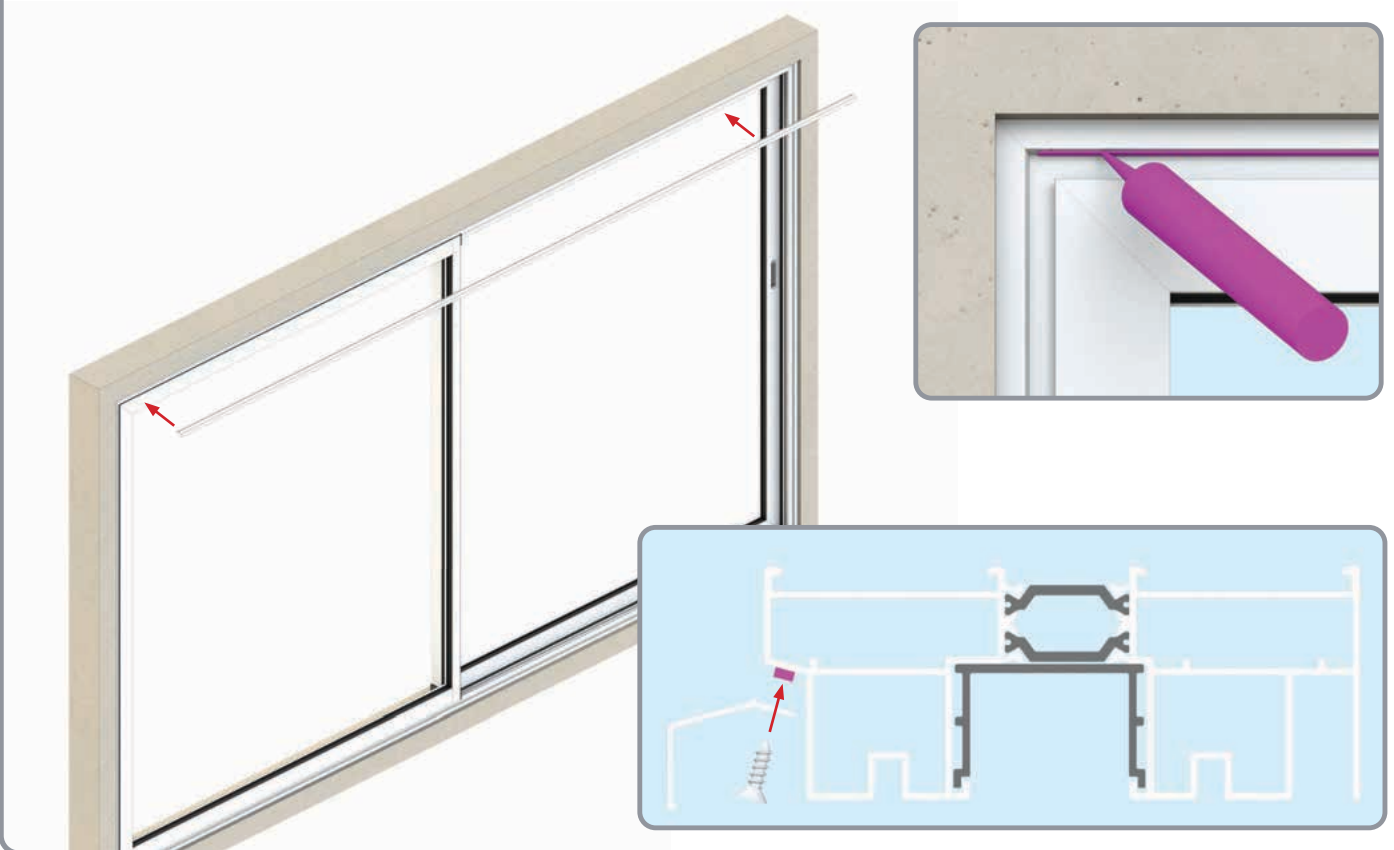

Install trickle vents over apertures using screws provided

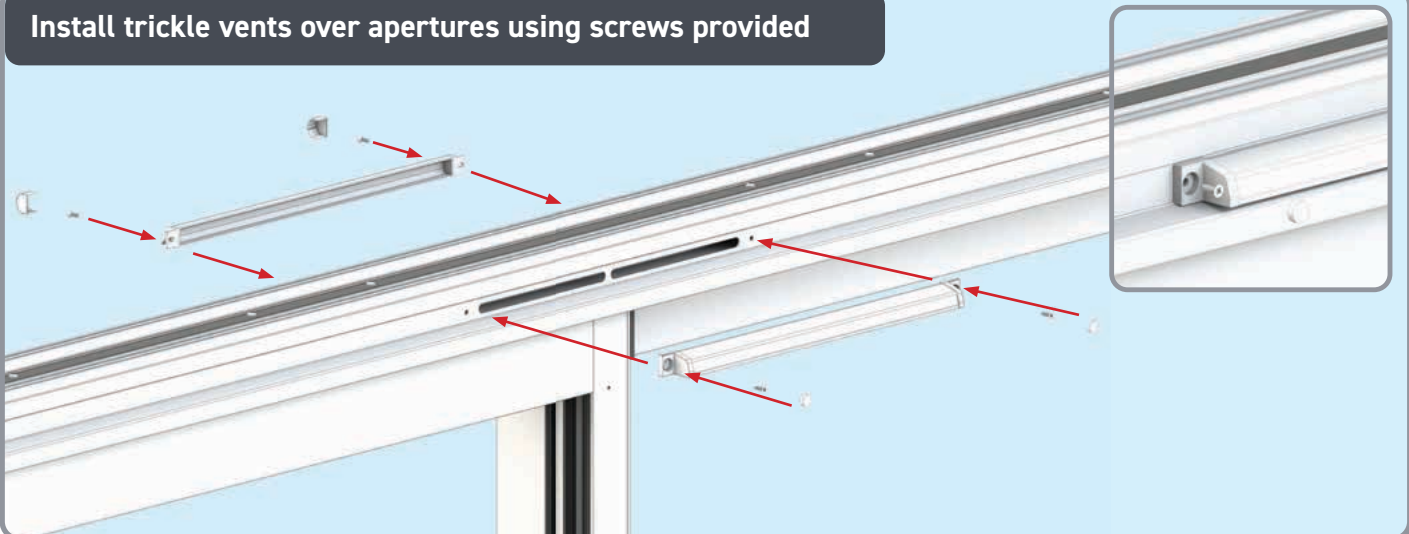

# OPTIONAL - REINFORCEMENTS

# 13



Fit reinforcement to required door. Fix using screw provided

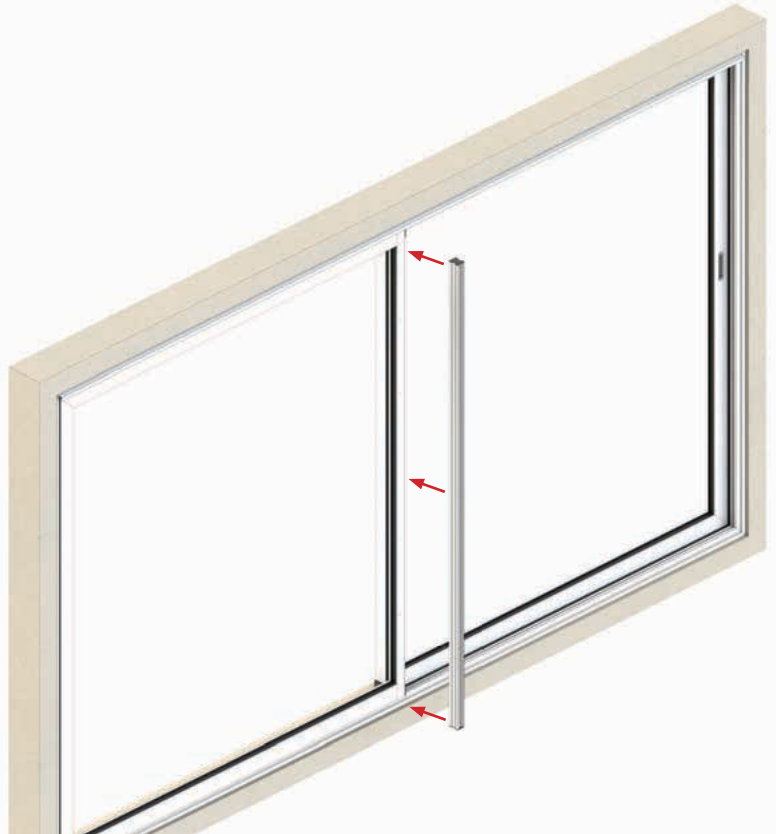



# INSTALL TRACK COVERS

14



Low modulus silicone sealant

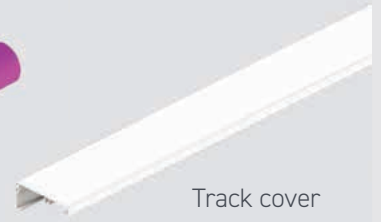

Track cover

Run a bead of silicone 100mm long every 400mm into the frame ready for installing the track covers

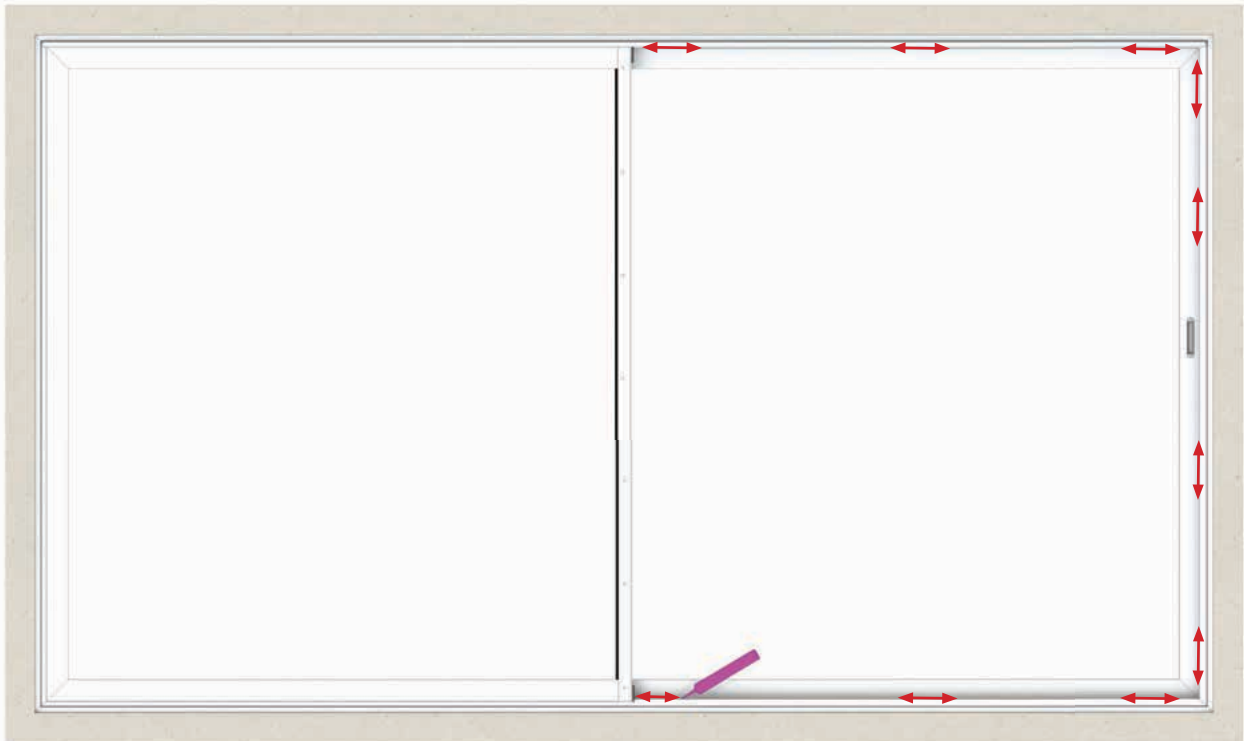

Fit the vertical covers before fitting horizontal covers

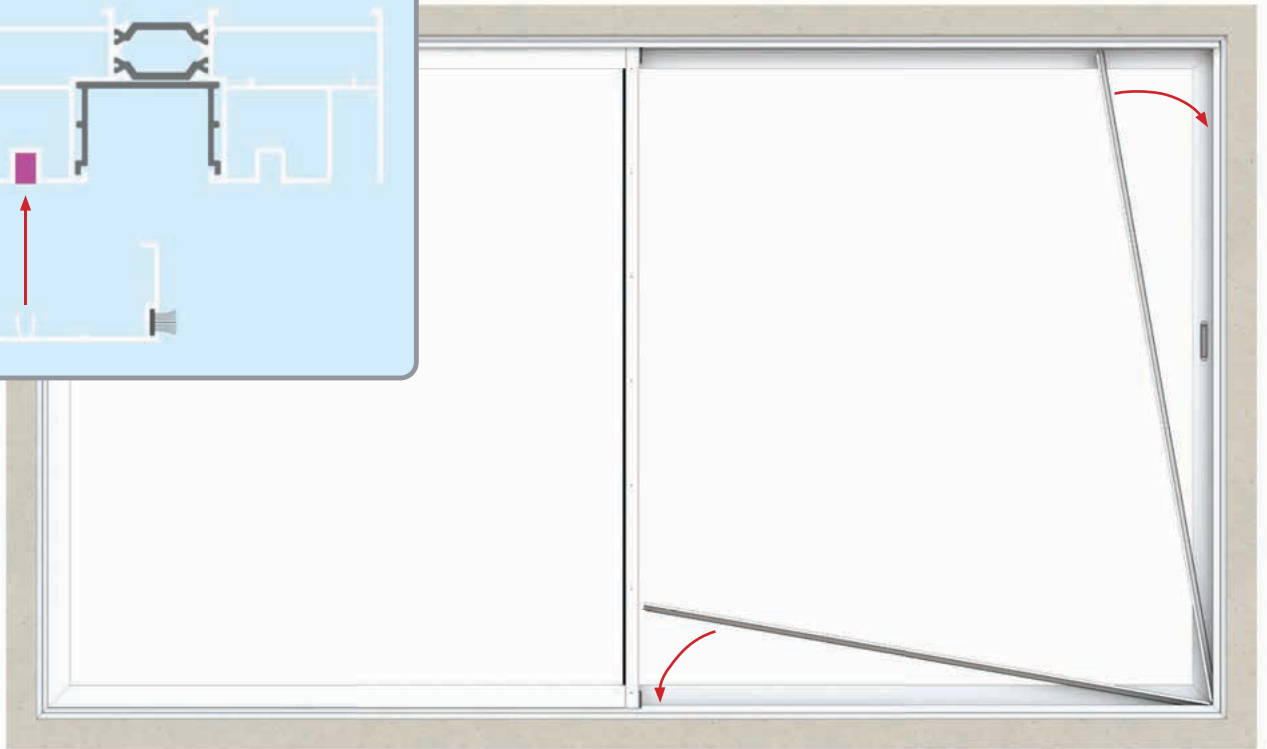
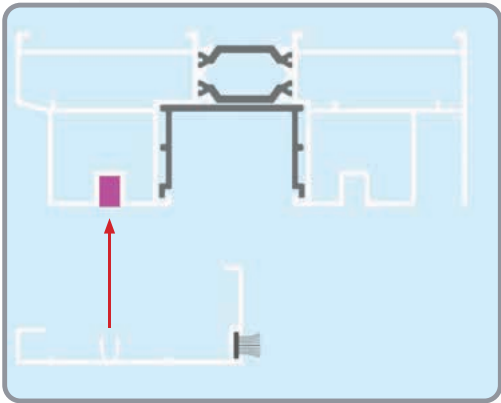

OPTIONAL - APPLY SEALANT TO CILL

15



Low modulus  
silicone sealant

Using permeant silicone seal around the frame where shown

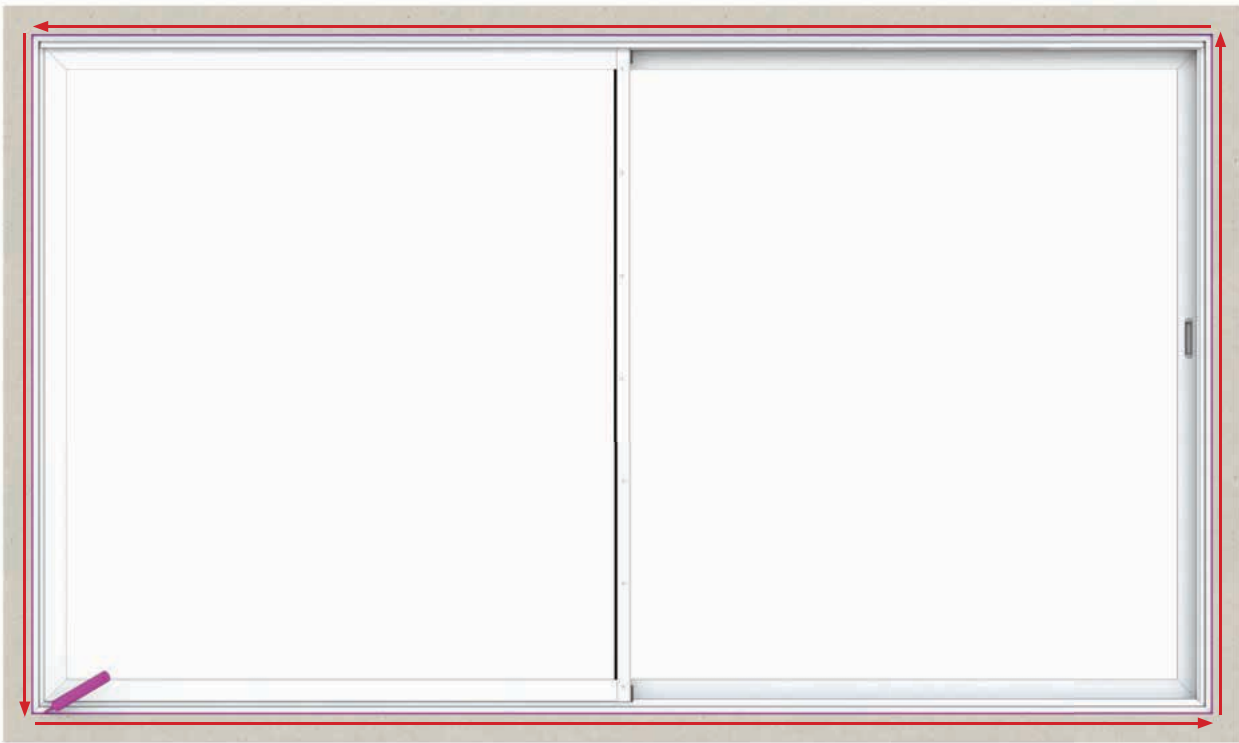

Wipe clean any excess silicone

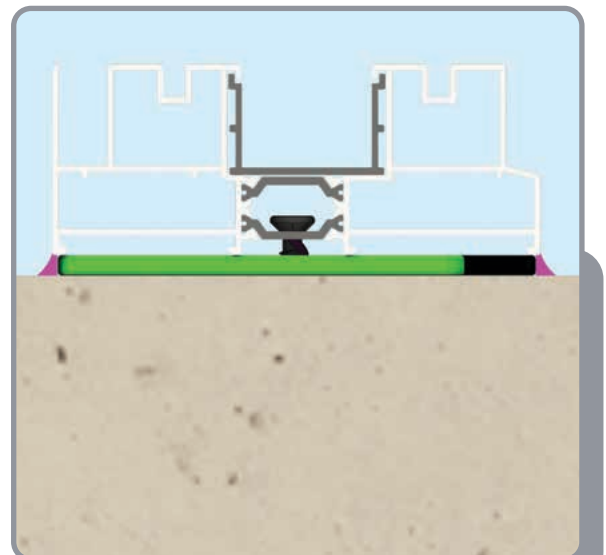



[www.korniche.co.uk](http://www.korniche.co.uk)